

KurbX® - Customizable Structural Shower Pans

✓ CURBED

✓ CURBLESS

✓ DOG WASHING STATIONS

✓ UNDER WATER FED APPLIANCES

KurbX® structural shower pans combine the strength & durability of a traditional mud-set with the versatility of foam.

Product Description

- Proprietary, patented system
- Pre-sloped, structural shower pan that replaces the subfloor to create a curbless shower
- Created from glass reinforced plastic, produced by compression mold
- Cover with any size or style solid surface floor covering

Physical Description

- Thin profile – 15/16" thick at perimeter
- Self supported on 16" O.C. floor joists
- Four precision engineered gradients/slopes
- Centered and tub replacement drain location
- Unique, textured surface
- Ribbed underside
- Pre-drilled screw holes
- Gray in color
- 100% recyclable

Versatility of Product

- Unique design allows all KurbX pans to be set directly to any substrate
- Thin profile, structural pans can span 16" O.C. joists making curbless installs simple and cost effective
- All pan sizes can be cut to any shape or size on site or placed side by side for large showers
- Unique, textured surface provides superior waterproofing adhesion
- Drains are centered in pan for optimal design orientation making large format installations flawless
- Drain connection to the pan is self contained which removes the need for any additional waterproofing or gaskets
- Structural pans are durable enough to be installed during the rough framing phase of construction and re-useable
- System is compatible with any size or style of solid surface floor covering or heating application
- KurbIT®! Simply add a curb to any KurbX system to create a curbed shower

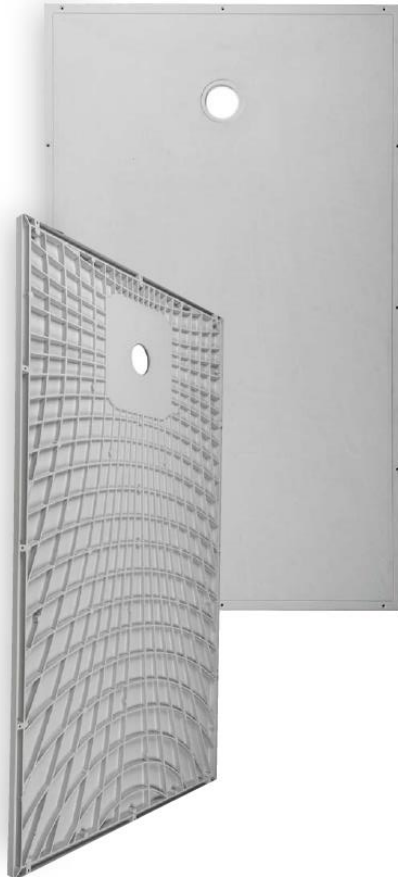

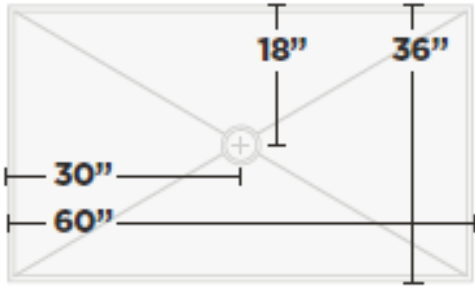

60" x 36" KurbX®
Center Drain Shower Pan
| SB6036-CD

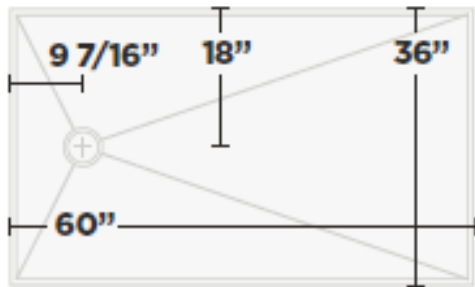
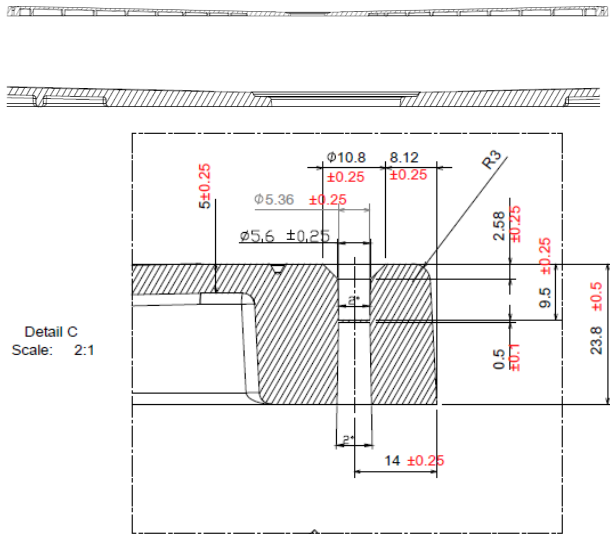

60" x 36" KurbX®
Offset Drain for Tub Replacement
| SB6036-OD-TR

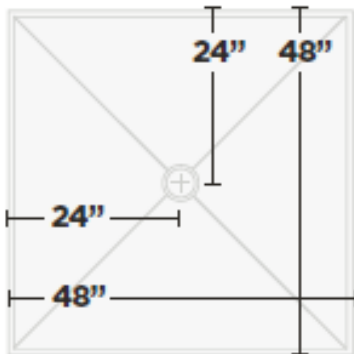
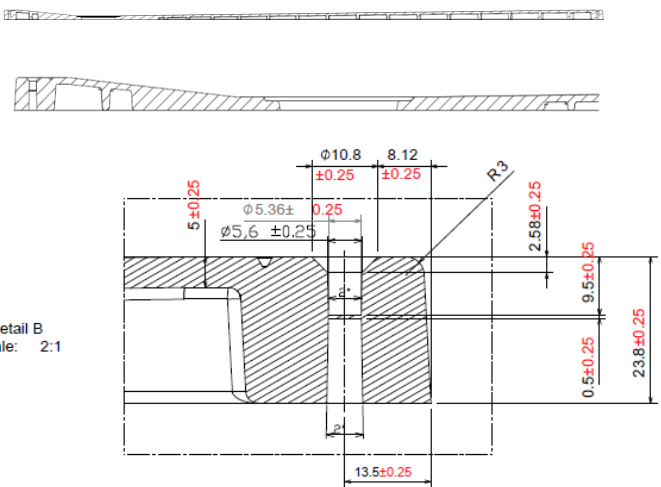

48" x 48" KurbX®
Center Drain Shower Pan
| SB4848-CD

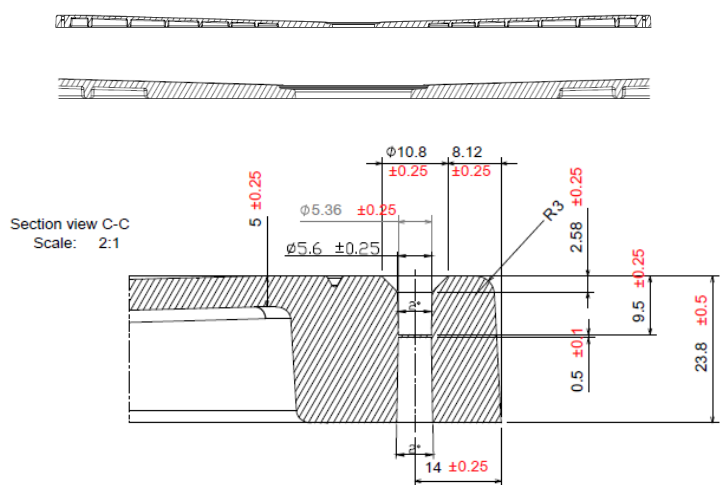

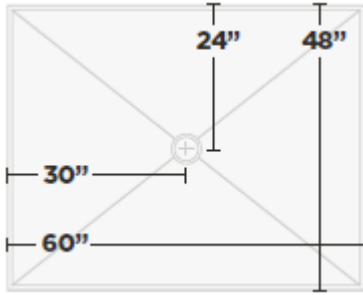

60" x 48" KurbX®
Center Drain Shower Pan
| SB6048-CD

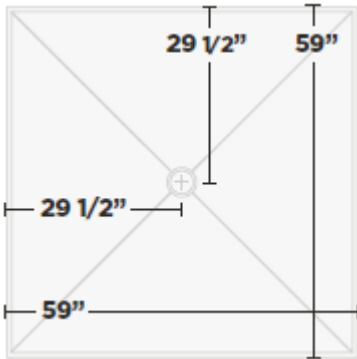
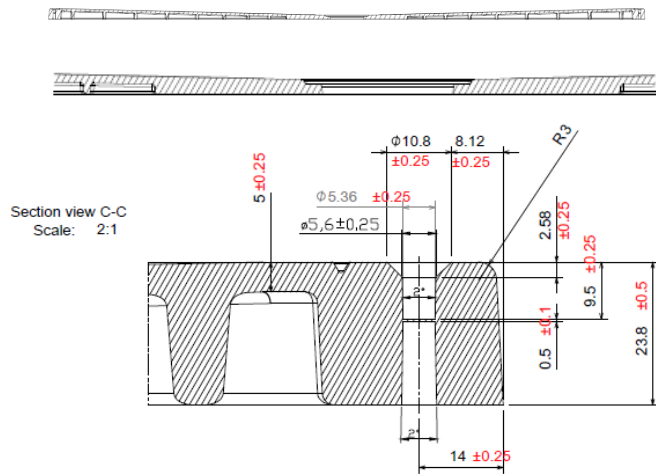

60" x 60" KurbX®
Center Drain Shower Pan
| SB6060-CD

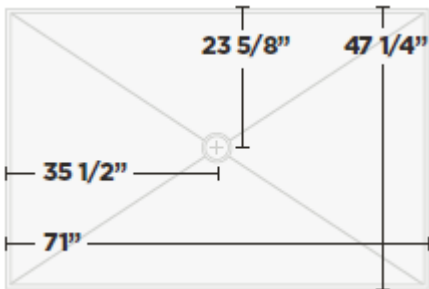
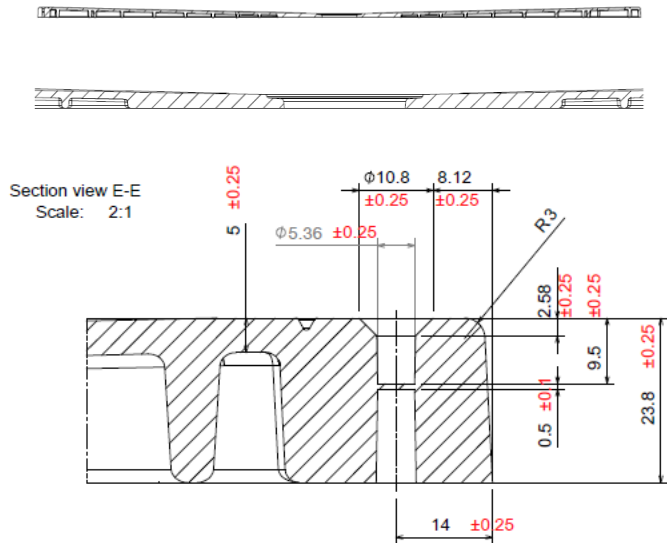

72" x 48" KurbX®
Center Drain Shower Pan
| SB7248-CD

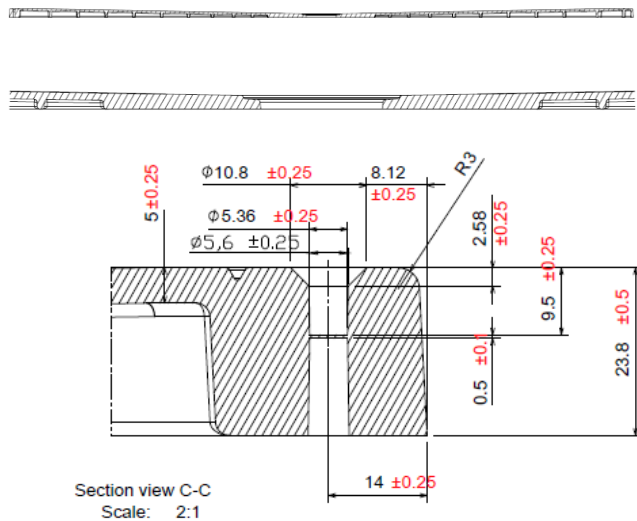

Compliance

- ICC-ES PMG-1643 in compliance with:
 - 2021, 2018, 2015, 2012, and 2009 *International Plumbing Code*® (IPC)
 - 2021, 2018, 2015, 2012, and 2009 *International Residential Code*® (IRC)
 - 2021, 2018, 2015, 2012, and 2009 *Uniform Plumbing Code*® (UPC)
 - 2017 *Uniform Illustrated Plumbing Code-India*™ (UIPC-I)
 - 2020, 2015, and 2010 *National Plumbing Code of Canada*® (NPC)
 - TCNA/ANSI A118.10-2014(R19), Load Bearing, Bonded, Waterproofing Membranes for Thin-Set Ceramic Tile and Dimension Stone Installation
 - ASME A112.18.2/CSA B125.2-2020, Plumbing Waste Fittings
 - IAPMO PS 106-2015e1, Tileable Shower Receptors and Shower Kits

Warranty

- All KurbX® shower pans carry an extended, limited lifetime warranty
- SeeLIT® Waterproofing carries a standard 10-year limited warranty